

HANDLE RETURN SPRING REPAIR KIT

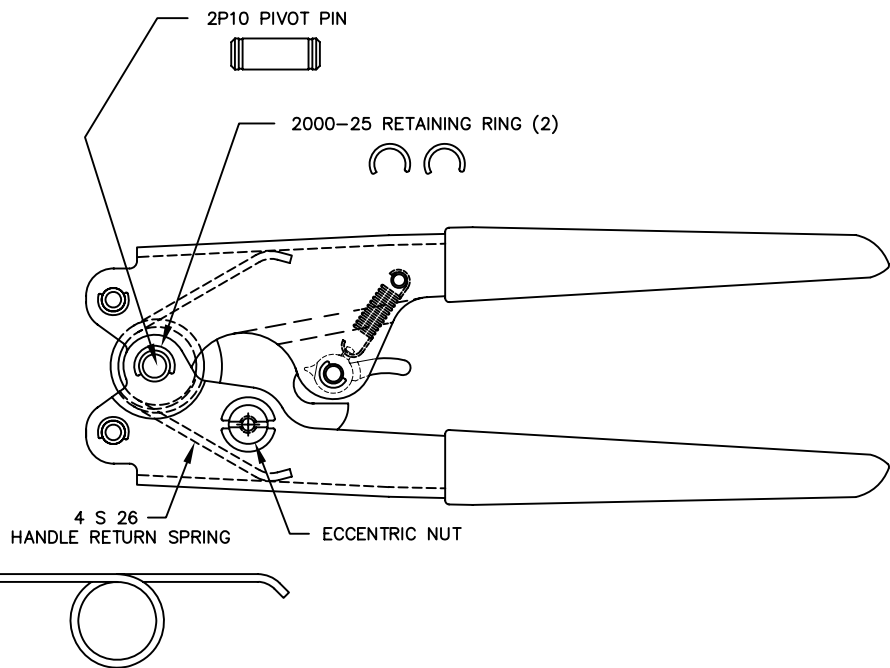

OPPOSITE SIDE

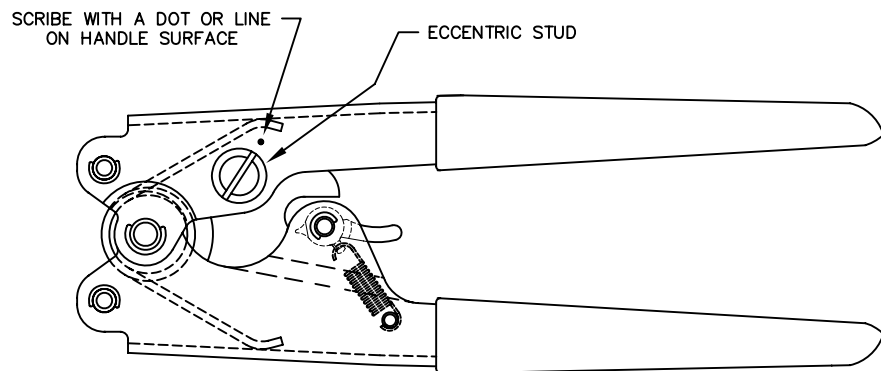

REPAIR PROCEDURE

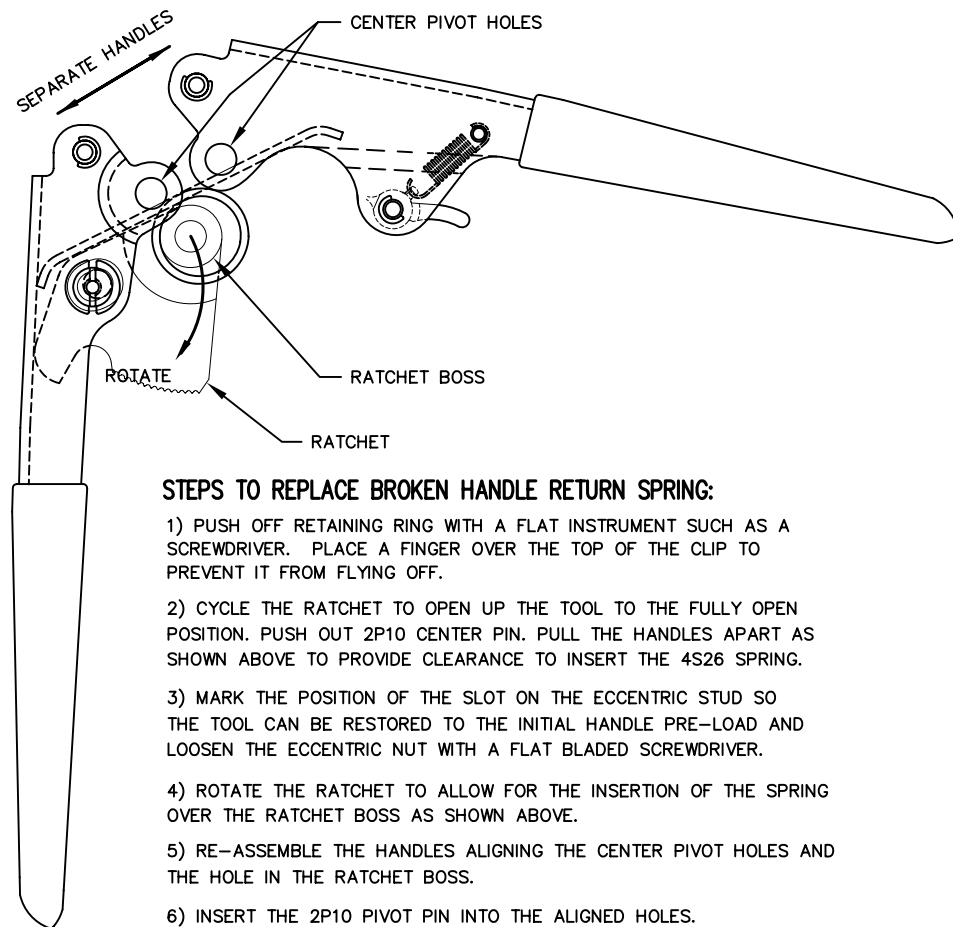

STEPS TO REPLACE BROKEN HANDLE RETURN SPRING:

- 1) PUSH OFF RETAINING RING WITH A FLAT INSTRUMENT SUCH AS A SCREWDRIVER. PLACE A FINGER OVER THE TOP OF THE CLIP TO PREVENT IT FROM FLYING OFF.
- 2) CYCLE THE RATCHET TO OPEN UP THE TOOL TO THE FULLY OPEN POSITION. PUSH OUT 2P10 CENTER PIN. PULL THE HANDLES APART AS SHOWN ABOVE TO PROVIDE CLEARANCE TO INSERT THE 4S26 SPRING.
- 3) MARK THE POSITION OF THE SLOT ON THE ECCENTRIC STUD SO THE TOOL CAN BE RESTORED TO THE INITIAL HANDLE PRE-LOAD AND LOOSEN THE ECCENTRIC NUT WITH A FLAT BLADED SCREWDRIVER.
- 4) ROTATE THE RATCHET TO ALLOW FOR THE INSERTION OF THE SPRING OVER THE RATCHET BOSS AS SHOWN ABOVE.
- 5) RE-ASSEMBLE THE HANDLES ALIGNING THE CENTER PIVOT HOLES AND THE HOLE IN THE RATCHET BOSS.
- 6) INSERT THE 2P10 PIVOT PIN INTO THE ALIGNED HOLES.
- 7) PLACE ONE OF THE 2000-25 RETAINING RINGS ON TOP OF THE HANDLE AND ALINGNING IT WITH THE GROOVE IN THE PIVOT PIN, PUSH IT ONTO THE PIN UNTIL FULLY SEATED.
- 8) REPEAT WITH THE OPPOSITE SIDE.
- 9) ALIGN THE SLOT ON THE ECCENTRIC WITH THE MARK YOU MADE ON THE HANDLE AND TIGHTEN THE NUT WITH A FLAT BLADED SCREW DRIVER. WHEN TIGHTENING THE NUT PLACE A FINGER OVER THE HEAD OF THE ECCENTRIC STUD ON THE OPPOSITE SIDE TO PREVENT IT FROM TURNING. CHECK ALIGNMENT OF THE MARK AND ADJUST AS NECESSARY.